

2023 Washtenaw Elementary Science Olympiad Tournament

Guide for Parents and Coaches



Venue

Huron High School
2727 Fuller Road
Ann Arbor, MI 48105

May 13, 2023
8:00 am - 9:00 pm
Doors open at **7:30 a.m.**

Tournament Logistics

The WESO Tournament is a fun and exciting day. With all that excitement comes some logistical challenges. Huron High School is a new venue for us and we ask that all of our guests and participants come with patience and courtesy in mind. Please give yourself plenty of time to find parking, use the shuttle, find your school's homebase and check-in for your event. **We do not allow late arrivals to events!**

Parking

Parking at Huron is limited and we encourage families to use the shuttle (see below). There are several parking lots at Huron, some of which will be reserved for Board Members, Event Supervisors, Key volunteers, Head Coaches (1 per school), and other VIPs. Access to those lots will require a parking permit. (Head Coaches will be able to pick up their parking permit on Friday 5/12 at Huron between 4:00 pm and 8:00 pm.) Additional lots for the general public have limited spaces. Parking is not allowed on grassy areas, along Huron Parkway or Fuller Road. In addition, parking at Furstenberg and Gallup Park is not recommended as these spaces are designated for visitors to those parks and restrictions apply.

The main entrance to Huron High School is off of Fuller Rd. There is an additional entrance off of Huron Parkway which will be used by the shuttle and those parking in reserved lot A. Please see the parking map on page 8 or click here [HHS Parking Map](#).

There is an area designated for student drop. Students should be dropped off with an adult or with an adult waiting to receive them. No unaccompanied students! Cars found to be parked in the drop-off area or in any no parking zone may be towed as parked cars may block fire lanes or present a safety hazard.

Shuttle

Parking will be a challenge especially during overlap times between award ceremonies and the start of the next grades events. We encourage parents to use the free shuttle service that will run from the UM lot on Glazier Way to Huron High School from 10:00 am to 9:30 pm. Please see the shuttle map on page 9 or click here [Shuttle Map](#).

School “Homebase” Areas

Each school will have access to a marked space under the arch between the East and West buildings of Huron High School. Space selection will be first come, first served. **This is the first place families should go when they arrive at Huron High School.** Teams are invited to bring tables, chairs, blankets, and food and beverages. There are additional spaces around the high school and on the grass that teams/families are welcome to use if the weather permits. There will be limited seating available in the cafeteria. Tables in the cafeteria or on the surrounding exterior patios are not meant for prolonged occupancy and may not be saved by teams. Please see the overview map on the last page or click here [Tournament Overview Map](#)

Events

Participation Waivers

This year the WESO Board has collected electronic waivers for every WESO participant. Wristbands will be distributed to each head coach for students whose waivers were submitted in advance of the May 5th deadline. *For students whose waivers were submitted after this deadline, they will need to pick up their wristband at the Information Table located on the first floor of the west wing lobby.* Wristbands are color-coded for grade-level and students may not enter the event without their wristband indicating a signed waiver. Please ensure that your students have a wristband prior to presenting at Academic Check-in.

Academic Event Check-in

For the majority of events, the check-in will be immediately inside the entrance to the East Wing of Huron High School from the arch area. Ask your head coach or consult a map for directions. Exceptions are Pentathlon and On Target (see below for check-in locations for these).

Student teams should arrive at Academic Check-in 10-15 minutes prior to the scheduled event start time. Check in your whole team at once if possible. Only students with a wristband will be allowed to check in. In order to avoid a large crowd at the check-in station, please designate **one adult** to escort your team to the area. Once the students have been dropped off, this person should leave the area. Students will be escorted from the academic check-in area to their event competition area by volunteers. None of the events allow for spectators. Students are expected to be in the competition rooms, ready to go at the event start time. Late arrivals to the competition room will not be admitted. Students exiting from events on the east wing will exit the building from an exit door on the north side of the staircase.

Pentathlon and On Target Check-in

Pentathlon and On Target take place in the annex gym in the West Wing. Check in for these events will be in a hallway directly off of the first floor lobby of the West Wing. There will be signs directing participants to the check-in area for these events. Students exiting from On Target or Pentathlon will be returned to the lobby of the west wing.

All students will exit the event areas when finished even if they have an event immediately following. They will need to recheck in at the academic check-in desk for their next event.

*For safety reasons, we cannot allow anyone who is not participating in an academic event, or actively volunteering, to enter the academic hallways. **This means that parents and coaches will not accompany students to their events.*** There are many adult volunteers and trained supervisors to help your students get where they are going. There will be signs and volunteers to help you identify public and off-limits areas of the school. Your cooperation is expected and appreciated.

Awards Ceremonies

Awards ceremonies will be held in the large gym. The times are

2nd Grade: 11:15 am

3rd Grade: 2:15 pm

4th Grade: 5:15 pm

5th Grade: 8:15 pm

Ceremonies usually last about 45 minutes.

Seating

Schools will have their teams sit on the gym floor as a group. The school head coach(es) will sit with the students. A few event coaches may also sit in this area but we ask that you restrict the number of adults seated with your team as there is limited space and we want to prioritize seating for the students.

Parents, siblings, and other guests should sit in the stands.

Banner Parade

Awards ceremonies begin with a banner parade. Please assign only two Olympians to carry your school banner. Have those students at the large gym 15 minutes before the start of the award ceremony so we can order them alphabetically by school. Banners should be 3 feet in length or less – larger banners do not fit in the designated aisles and create a safety hazard.

Medals

Medals will be presented to 1st – 5th place finishers for each event in each grade, plus 3 honorable mentions. Each competing student will receive a medal if their team places.

Teams to receive medals for an event will be called to the stage, and medal placements will be announced starting with honorable mentions, then places 5, 4, 3, 2, and 1.

The number of medals provided to a school for an event is equal to the maximum team size for that event. We cannot provide additional medals for students who are alternates for an event, or participated in practices, etc.

Sportsmanship

Students and parents are expected to exhibit outstanding sportsmanship during awards ceremonies, including listening to speakers, being respectful of each other, and celebrating the accomplishments of all schools, not just their own. Medals are an important part of WESO, but our ceremonies are designed primarily to celebrate science education and the progress all of our students have made in learning new and exciting STEM topics.

Noise

It can get very loud in the gym at times, which makes it difficult to hear the speakers. You and your students can help this by listening quietly when someone is speaking and keeping noise to a minimum. Coaches and parents, it is up to you to monitor your students.

Handicap Access for the Award Ceremonies

There is limited handicap access to the gym. If you have students, parents or other individuals that need an elevator to access the 2nd floor, please see the volunteers at the Information Table in the 1st floor

lobby of the West Wing. They will direct you to volunteers who can escort you to the appropriate elevator. Please keep in mind that it is a long walk to the gym elevator access point.

Cafeteria

Food & Drinks: With the exception of pre-ordered pizzas, there will be no food or beverage sales at this year's Olympiad. Each school is welcome to bring outside food and drinks to this year's event but due to the limited parking and traffic flow, outside deliveries will not be allowed.

Consumption of all food and drinks will be limited to the cafeteria or outdoors. This rule will be strictly enforced.

Raffle: There will be a variety of gift baskets for raffle during the tournament. Please participate and purchase some tickets! WESO relies on raffle ticket sales to support the tournament. Raffle tickets are 1 ticket for \$5, 3 tickets for \$10, and 7 tickets for \$20. The drawings will take place at 7:00 pm in the cafeteria. You do not need to be present to win a drawing.

Donated raffle baskets should be dropped off in the cafeteria on Friday evening. Please be sure to submit a list of items in the basket along with the name of the school.

Pin and Lanyard Sales

We will be selling WESO pins and lanyards. The price is \$5 for 3 pins or 2 pins and a lanyard. These items will be sold at the same location as the raffle tickets.



and more!

Open Events

Open Events are located in the cafeteria. We will have exploratory stations in Physics, Chemistry, Biology, Math, Technology, and more, as well as representatives from a variety of local groups.

All children (WESO participants, siblings, friends, etc.) are welcome to participate in Open Events. We hope the students find the events fun and informative.

T-shirts and Identification

WESO uses t-shirts of various styles to make identification of participating students, supervisors, board members, and coaches as easy as possible.

Students

All team members should wear their school's t-shirt and have a name tag that identifies them by first name, grade level, and the names and start/end times for each event they are participating in.

Handwritten name tags are fine.

Rebecca

3rd Grade

Estimania 12:00 – 12:20

Map Reading 1:00 – 1:25

School Head Coaches, Event Coaches, and Parents

These adults may wish to wear a t-shirt that is the same as the student t-shirt for their school. It is a great way to show school spirit. Otherwise, adults may dress as they wish.

WESO Board Members

Board members will be wearing multi-colored tie-dye t-shirts and lanyards with name tags. These t-shirts have the WESO Owl logo on the upper left. There is usually a board member in the gym area, another in the cafeteria, and one in the academic hallway. If you can't find one, visit the General Information table in the west lobby, and they will help you locate someone.



Supervisors and Key Volunteers

Supervisors and Key Volunteers have been recruited from WESO schools and the community, and are given special training to help run certain areas of the tournament. They can be found at several areas of the building, including Open Events, Volunteer Check-in, and Academic Check-in. Many supervisors work behind the scenes running the events. They will be wearing purple swirl t-shirts with an owl on the top left, and will have a name tag that says "Supervisor". Feel free to ask them for help and advice as you navigate the building and the tournament schedule.



Volunteers

Volunteers should check in at the Volunteer Check-in Table located in the east side lobby 10 minutes before their assigned time. Please use the appropriate set of doors designated for Volunteer Check-in. You will need to wear a special name tag if you are working at an academic event or in the academic wing; for safety reasons, only assigned volunteers are allowed in the academic event hallways.

Email reminders with information about volunteer shifts will be sent to Head Coaches.

Safety

We are anticipating thousands of students, parents, and coaches, and need everyone's cooperation to maintain safety and security throughout the building. Security guards will be present both inside the building and outside, in the parking lots and throughout the tournament. Security is everyone's responsibility. Please monitor your children! Children should not be left unattended or allowed to roam about the school grounds unaccompanied. Be mindful that there is a great deal of traffic flow all day long. If you have a security concern, please contact a board member, security guard or go to the Information table.

Call 911 in case of a life-threatening medical emergency.

First Aid kits are available at the Information Table. **Automated External Defibrillators (AEDs)** are available at various locations in the school. Check the maps in the hallways for locations.

Indoor Safety

All event spaces will have several adults present. It is WESO's policy that students are never left alone. Teams are escorted to their event rooms by volunteers. When a team has completed their testing, they will be released by the Event Supervisor. Volunteers will be posted throughout the hallways to direct students to the proper exit. Additional signage is also present to assist students in exiting.

Many areas of Huron High School are off limits to WESO participants and guests. Please stay out of any areas that have "Caution" tape or are marked "Do Not Enter." Do not open any locked exterior doors, and do not go beneath the bleachers in the large gym.

As with every WESO competition, there will be armed security guards present both inside and outside the building. In addition, the Ann Arbor Police Department has been notified of our event. Plans are in place to assure only approved individuals are in the building and routine checks of all exterior doors will occur to assure they remain closed and locked. In the event of an emergency, all event supervisors have been instructed to follow posted emergency instructions located in each classroom.

Outdoor Safety

Please see the attached map for detailed parking and entrance information. We will have volunteers and security outside to assist with traffic control as needed to maintain a safe movement in and around Huron High School. All participants should come prepared for the weather. Water, sunscreen, protective clothing, and umbrellas should be brought by each school. Please note the average temperature in Ann Arbor for May 13th is between 65-75 degrees. Inclement weather: We do not anticipate extreme weather to affect this year's Olympiad. All of the events and ceremonies will be held indoors. Should heavy rain and/or thunder and lightning occur, teams should remain under the arch area or they may come into the cafeteria or the west side lobby.

Sponsors

WESO is supported by numerous local sponsors, without whom the tournament would not be possible. Sponsors have given grants, provided volunteers, prepared and taught workshops, or made other contributions of their time and talent. Take a moment to check out the "Thank you!" posters in the hallways and thank our sponsors if you get a chance. Where possible, please support the businesses that support WESO.

Representatives of sponsor companies will be recognized at the ceremonies, and may help distribute medals.

Miscellaneous Topics

Concerns or questions about an event

Any concerns or questions regarding a specific event should be **brought to head coaches first**. Head coaches may then submit concerns at the Volunteer Check-in table and an appropriate WESO board member will be contacted. Please remember that **supervisors have authority over scoring their events**, including resolving ties. They will answer questions from student participants before the event begins. If you (parent or coach) have a concern, take your concern to your school's head coach who should direct it to a WESO board member.

All other concerns may be brought directly to any of the board members or to the Volunteer Check-in table.

WiFi

There is a public WiFi connection in the school, but due to the large number of people who will be there during the day, do not expect fast connections. WESO is not responsible for the WiFi, and cannot help with connection or device problems.

Final Thoughts

As you and your Olympian participate at WESO, don't forget that everyone who is working hard to make this possible is a volunteer, including you.

Thank you for all you've done to put STEM education front and center in Washtenaw County!

Best wishes to all the teams!

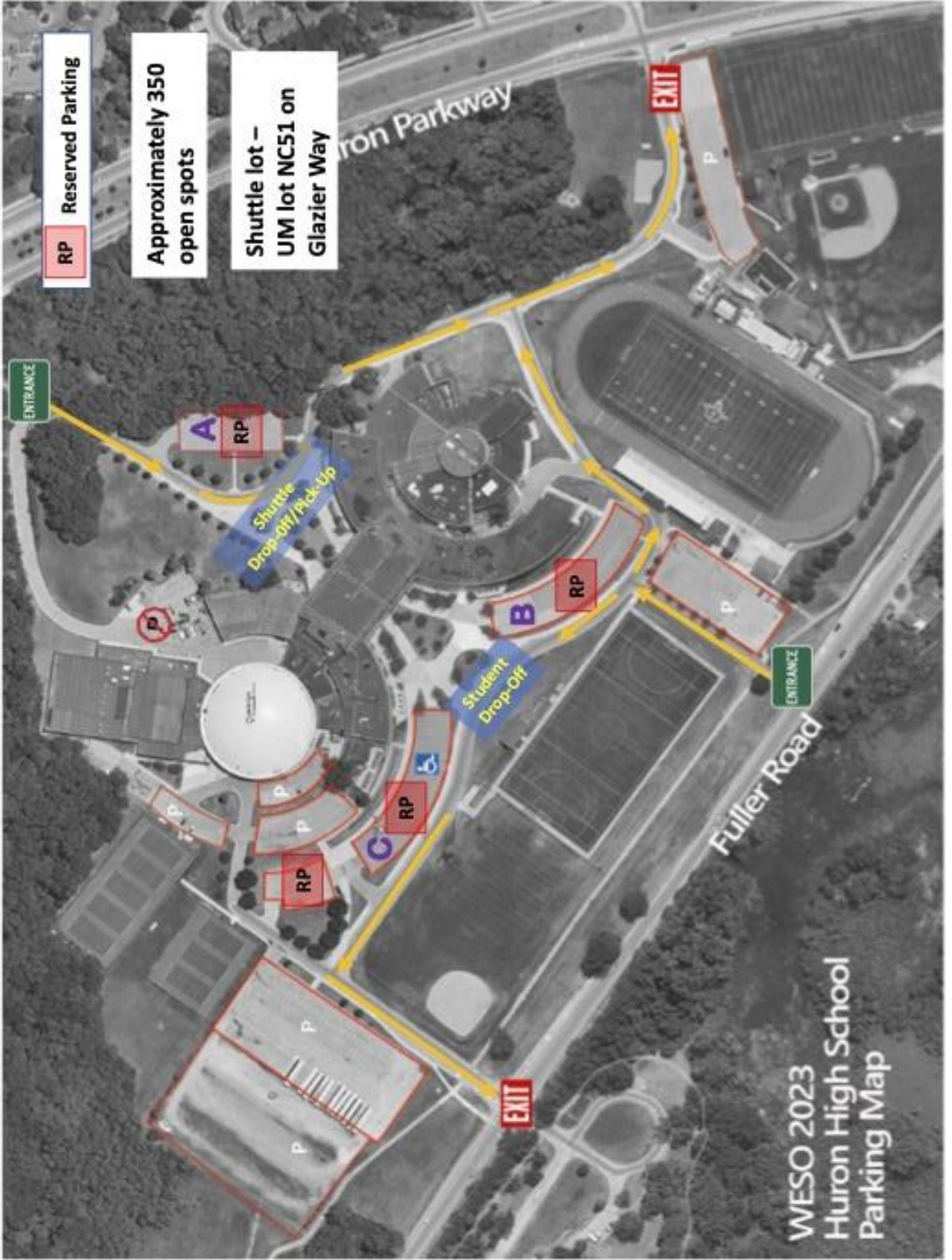

WESO 2023
 Huron High School
 Parking Map

Shuttle lot
UM NC51 on
Glazier Way

Shuttle will run
from 10:00 am
through 9:30 pm

Huron High School
2727 Fuller Rd.
Main Entrance on
Fuller



